

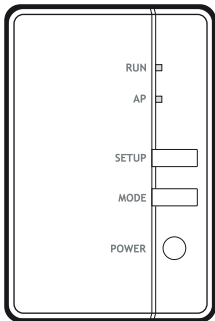

# Installation manual

## Wireless LAN connecting adapter BRP069C41



**BRP069C41**

**BRP069C51**  
**BRP069C81**  
**BRP069C82**

# Table of contents

<b>1</b>	<b>About this document</b>	<b>3</b>
<b>2</b>	<b>Specific installer safety instructions</b>	<b>4</b>
<b>3</b>	<b>About the adapter</b>	<b>6</b>
3.1	Components.....	6
3.2	Basic parameters .....	6
3.3	Compatibility .....	7
<b>4</b>	<b>About the box</b>	<b>7</b>
4.1	To unpack the adapter .....	7
<b>5</b>	<b>Installation</b>	<b>8</b>
5.1	Precautions when installing the adapter .....	8
5.2	Preparing the installation site.....	8
5.2.1	Installation site requirements .....	8
5.3	Connecting the electrical wiring .....	8
5.3.1	Overview of electrical connections.....	9
5.3.2	To connect the adapter with the unit.....	10
5.4	Closing the adapter .....	11
5.4.1	To close the adapter .....	11
5.5	Mounting the adapter .....	12
5.5.1	To mount the adapter.....	12
<b>6</b>	<b>Starting up the system</b>	<b>13</b>
<b>7</b>	<b>Configuration</b>	<b>14</b>
7.1	To install the ONECTA app.....	14
7.2	To configure the adapter.....	14
<b>8</b>	<b>Hand-over to the user</b>	<b>14</b>

# 1 About this document

## Target audience

Authorised installers

## Documentation set

This document is part of a documentation set. The complete set consists of:

- **General safety precautions:**
  - Safety instructions that you must read before installing
  - Format: Paper (in the box of the indoor unit)
- **Installation manual:**
  - Installation instructions
  - Format: Paper (supplied in the kit)
- **Installer reference guide:**
  - Installation instructions, configuration, application guidelines, ...
  - Format: Digital files on <https://www.daikin.eu>. Use the search function 🔍 to find your model.
- **Declaration of conformity:**



### **INFORMATION: Declaration of conformity**

Hereby, Daikin Industries Czech Republic s.r.o. declares that the radio equipment type BRP069C41 is in compliance with the Directive 2014/53/EU and S.I. 2017/1206: Radio Equipment Regulations 2017. The original declaration of conformity is available on <https://www.daikin.eu>. Use the search function 🔍 to find the declaration of conformity of your unit.

## 2 Specific installer safety instructions



### INFORMATION

For details on specifications, setting methods, FAQ, troubleshooting tips and the latest version of this manual, visit [app.daikineurope.com](http://app.daikineurope.com).



Latest revisions of the supplied documentation may be available on the regional Daikin website or via your dealer.

The original documentation is written in English. All other languages are translations.

## 2 Specific installer safety instructions

Always observe the following safety instructions and regulations.

**Installation** (see "[5 Installation](#)" [▶ 8])



### DANGER: RISK OF ELECTROCUTION

- Turn off the power supply before installing the adapter.
- Do NOT handle the adapter with wet hands.
- Do NOT let the adapter get wet.
- Do NOT disassemble, modify or repair the adapter.
- Grip the connector when disconnecting the connection cable.
- Turn OFF the power supply in case the adapter gets damaged.



### DANGER: RISK OF ELECTROCUTION

Do NOT turn on the power supply before you have connected the electrical wiring, closed the adapter, and mounted it to the indoor unit.

### Hand over to the user (see "8 Hand-over to the user" [▶ 14])



#### **DANGER**

- Do NOT disassemble, modify, or repair the adapter. This can cause fire, electrical shock, or injury.
- Do NOT allow the adapter to get wet or use it when bathing or doing similar activities with water. This can cause electrical shock or fire.
- Do NOT use the adapter near medical equipment, or persons using cardiac pacemakers or defibrillators. This can cause life-threatening electromagnetic interference.
- Do NOT use the adapter near auto-control equipment such as automatic doors or fire alarm equipment. This can cause accidents due to erroneous equipment behaviour.
- In case of abnormal odour or sound, overheating, or smoke coming out of the adapter, immediately disconnect the indoor unit from its power supply. Otherwise, this can lead to fire or malfunction. If this happens, consult your dealer.
- In case you drop or damage the adapter, disconnect the indoor unit from its power supply. Otherwise, this can lead to fire or malfunction. If this happens, consult your dealer.

## 3 About the adapter

# 3 About the adapter

Wireless LAN adapter to connect the heat pump system to the Daikin Cloud via the internet, allowing for control of the heat pump system with the ONECTA app.



### INFORMATION

For option model names BRP069C51, BRP069C81 and BRP069C82, wireless LAN adapter inside is BRP069C41.

## 3.1 Components

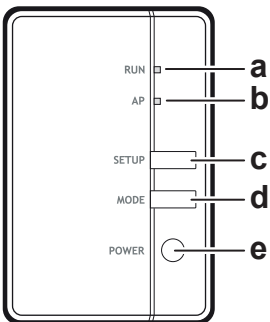

- a RUN lamp (orange). Lights when connecting to a router (wireless LAN access point).
- b AP lamp
- c SETUP button. Use when connecting to a router (wireless LAN access point).
- d MODE button
- e POWER button. Turns the WLAN adapter ON/OFF when pressed.

## 3.2 Basic parameters

Parameter	Value
Frequency range	2400 MHz~2483.5 MHz
Radio protocol	IEEE 802.11b/g/n
Radio frequency channel	13 ch
Output power	13 dBm
Effective radiated power	15 dBm (11b) / 14 dBm (11g) / 14 dBm (11n)
Power supply	DC 14 V / 16 V / 100 mA

## 3.3 Compatibility

Make sure the indoor unit is compatible for use with the adapter. For the latest details about installation of the adapter and applicable units, visit [app.daikineurope.com](http://app.daikineurope.com).

# 4 About the box

## 4.1 To unpack the adapter

1 Open the box.

2 Take out the adapter BRP069C41 from the option kit box (BRP069C51, BRP069C81 or BRP069C82).

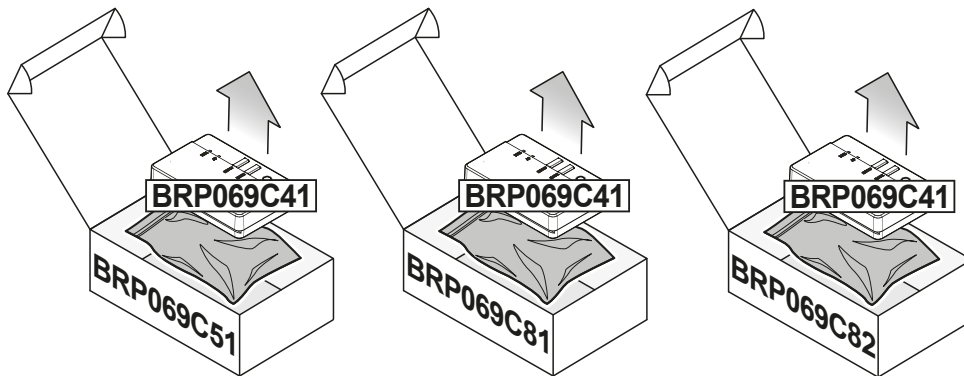

3 Separate the accessories.

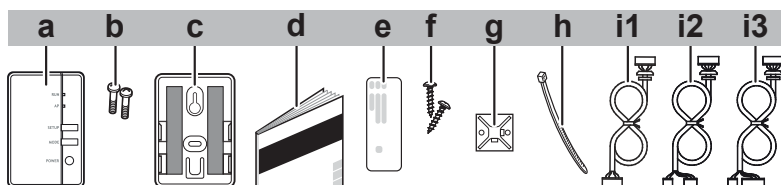

- a Adapter BRP069C41
- b Screws (M3×8) for the adapter
- c Adapter holder with double face tape
- d Installation manual
- e Serial number sticker (SSID, KEY, MAC)
- f Mounting screws for the holder (M3×16)
- g Cable tie holder
- h Cable tie
- i1 For BRP069C51: connection cable to X801A
- i2 For BRP069C81: connection cable to X35A + X50A (type 1)
- i3 For BRP069C82: connection cable to X35A + X50A (type 2)

# 5 Installation

## 5.1 Precautions when installing the adapter



### **DANGER: RISK OF ELECTROCUTION**

- Turn off the power supply before installing the adapter.
- Do NOT handle the adapter with wet hands.
- Do NOT let the adapter get wet.
- Do NOT disassemble, modify or repair the adapter.
- Grip the connector when disconnecting the connection cable.
- Turn OFF the power supply in case the adapter gets damaged.

## 5.2 Preparing the installation site

### 5.2.1 Installation site requirements

The adapter is designed to be mounted to the indoor unit, in dry, indoor locations only.

## 5.3 Connecting the electrical wiring



### **DANGER: RISK OF ELECTROCUTION**

Do NOT turn on the power supply before you have connected the electrical wiring, closed the adapter, and mounted it to the indoor unit.



## 5.3.1 Overview of electrical connections

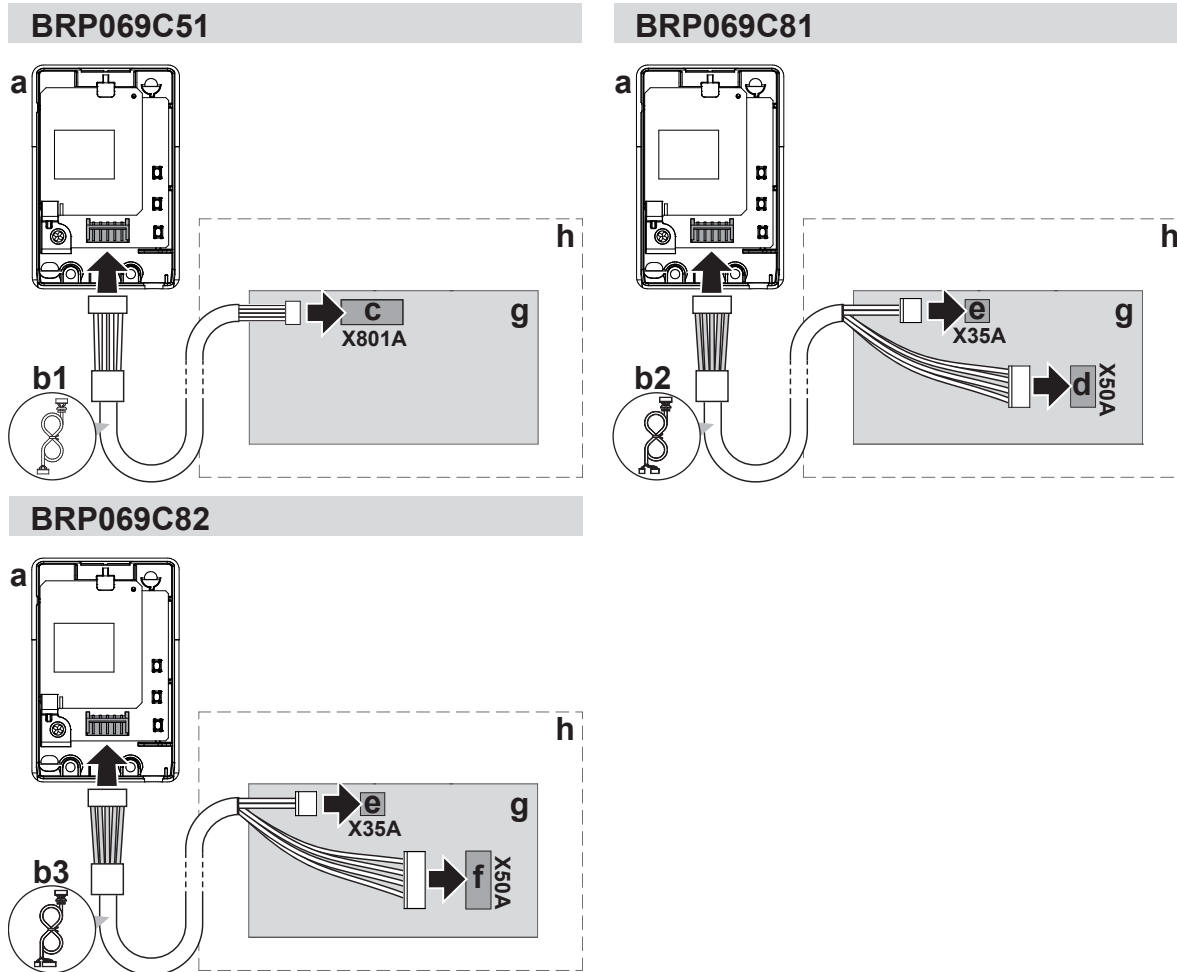

- a** Wireless LAN adapter BRP069C41
- b1** BRP069C51 connection cable
- b2** BRP069C81 connection cable
- b3** BRP069C82 connection cable
- c** PCB port X801A
- d** PCB port X50A (type 1)
- e** PCB port X35A
- f** PCB port X50A (type 2)
- g** Indoor unit PCB
- h** Indoor unit

## 5 Installation

### 5.3.2 To connect the adapter with the unit

1 Separate the upper casing from the lower casing.

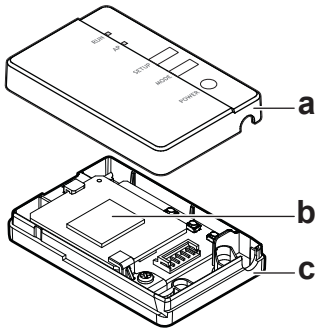

- a Upper casing
- b Adapter PCB
- c Lower casing

2 Connect the indoor unit side connector to the indoor unit PCB port.

- BRP069C51: PCB port X801A
- BRP069C81 and BRP069C82: X35A and X50A

3 Connect the adapter side connector to the adapter.

#### Connection cable for BRP069C51:

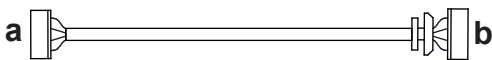

- a Indoor unit side connector X801A
- b Adapter side connector

#### Connection cable for BRP069C81:

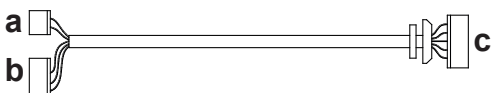

- a Indoor unit side connector X35A
- b Indoor unit side connector X50A (type 1)
- c Adapter side connector

#### Connection cable for BRP069C82:



- a Indoor unit side connector X35A
- b Indoor unit side connector X50A (type 2)
- c Adapter side connector

4 Fasten the cable and ensure strain relief.

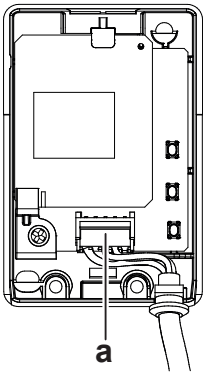

a Connector



### NOTICE

ALWAYS connect a wired or wireless remote controller (**Example:** BRC1H, BRC7), otherwise the online controller will NOT operate.



### INFORMATION

Provide strain relief at indoor unit side by using the cable tie and cable tie mounting that are included as accessory.

## 5.4 Closing the adapter

### 5.4.1 To close the adapter

1 Hook the front casing into the rear casing.

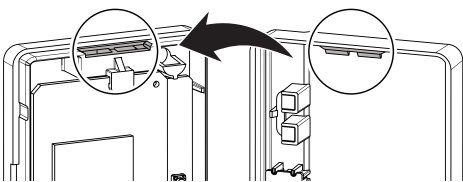

2 Insert the two screws from the accessory bag.

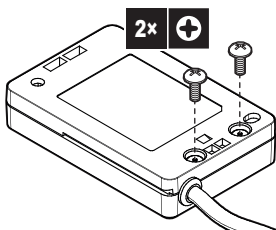

## 5 Installation

---



### NOTICE

After closing the adapter, check that the connection cable is securely fastened.

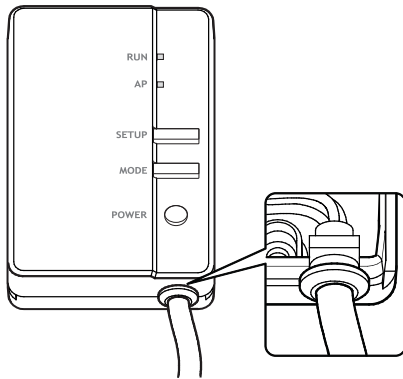

## 5.5 Mounting the adapter

Use the adapter holder (accessory) to mount the adapter. There are 2 ways of mounting the adapter holder:

- Fixing the adapter holder to the surface using screws.
- Fixing the adapter holder to the surface using double face tape.

### 5.5.1 To mount the adapter



### NOTICE

- If using double face tape for mounting, make sure that the part of the surface to which you mount the holder is clean and degreased.
- Make sure to mount the holder to the surface firmly, so that it can bear the weight of the adapter.



### INFORMATION

The exact location of the holder depends on the type of indoor unit. For more information, visit [app.daikineurope.com](http://app.daikineurope.com).

### When using screws

- 1 Fix the adapter holder on the wall/surface with 2 screws M3×16 (accessory).
- 2 Slide the adapter into the holder.

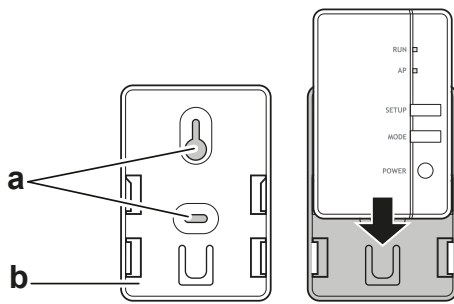

- a** Screw locations
- b** Adapter holder

### When using double side tape

- 3** Attach the double-sided tape to the adapter holder.
- 4** With the tape, mount the holder to the surface.
- 5** Slide the adapter into the holder.

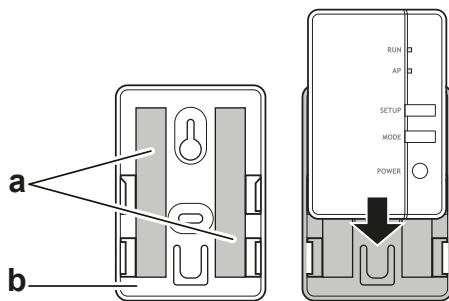

- a** Tape
- b** Adapter holder

## 6 Starting up the system

The adapter gets its power from the indoor unit. For the adapter to function, make sure it is connected to the indoor unit, and the indoor unit is powered on.

Turn on the power supply and check that the RUN lamp of the product blinks.

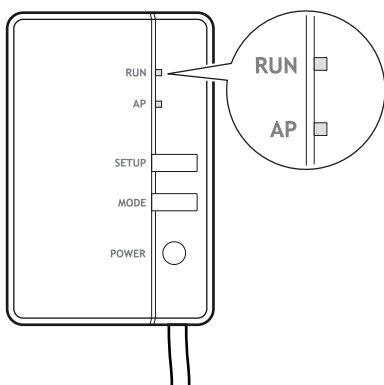

# 7 Configuration

The customer is responsible for providing:

- Smartphone or tablet with minimum supported version of Android or iOS, specified on [app.daikineurope.com](http://app.daikineurope.com).
- Internet line and communication device, such as a modem, router, etc.
- Wireless LAN access point
- Installed free ONECTA application.

## 7.1 To install the ONECTA app

1 Open:

- Google Play for appliances using Android.
- App Store for appliances using iOS.

2 Search for “ONECTA”.

3 Follow the directions on the screen to install.

## 7.2 To configure the adapter

Open the ONECTA application on your smartphone or tablet PC and follow the in-app instructions.

For this Wireless LAN adapter, WPS configurator is available, follow the in-app instructions.

[app.daikineurope.com](http://app.daikineurope.com)



# 8 Hand-over to the user

After having installed and configured the adapter, hand over this installation manual to the user and make him/her aware of the following safety precautions.



### DANGER

- Do NOT disassemble, modify, or repair the adapter. This can cause fire, electrical shock, or injury.
- Do NOT allow the adapter to get wet or use it when bathing or doing similar activities with water. This can cause electrical shock or fire.
- Do NOT use the adapter near medical equipment, or persons using cardiac pacemakers or defibrillators. This can cause life-threatening electromagnetic interference.
- Do NOT use the adapter near auto-control equipment such as automatic doors or fire alarm equipment. This can cause accidents due to erroneous equipment behaviour.
- In case of abnormal odour or sound, overheating, or smoke coming out of the adapter, immediately disconnect the indoor unit from its power supply. Otherwise, this can lead to fire or malfunction. If this happens, consult your dealer.
- In case you drop or damage the adapter, disconnect the indoor unit from its power supply. Otherwise, this can lead to fire or malfunction. If this happens, consult your dealer.



### NOTICE

Do not use the adapter near microwave ovens. This can affect wireless LAN communications.



CE

UK  
CA

**DAIKIN INDUSTRIES CZECH REPUBLIC s.r.o.**

U Nové Hospody 1/1155, 301 00 Plzeň Skvrňany, Czech Republic

**DAIKIN EUROPE N.V.**

Zandvoordestraat 300, B-8400 Oostende, Belgium

Copyright 2020 Daikin

4P567679-2H 2022.04